

1926

## Bath Hebrew Ladies Society (1923-26) (Yiddish)

Bath Hebrew Ladies Society

Follow this and additional works at: [https://digitalcommons.usm.maine.edu/jud\\_povich](https://digitalcommons.usm.maine.edu/jud_povich)

---

### Recommended Citation

Bath Hebrew Ladies Society, "Bath Hebrew Ladies Society (1923-26) (Yiddish)" (1926). *Povich, Donald M. Collection*. 42.

[https://digitalcommons.usm.maine.edu/jud\\_povich/42](https://digitalcommons.usm.maine.edu/jud_povich/42)

This Book is brought to you for free and open access by the Judaica Collection at USM Digital Commons. It has been accepted for inclusion in Povich, Donald M. Collection by an authorized administrator of USM Digital Commons. For more information, please contact [jessica.c.hovey@maine.edu](mailto:jessica.c.hovey@maine.edu).

*Given by Ads to All*

COMPOSITIONS

W-B 690



459.08 June 14

1923 24 153

Handwritten text in a cursive script, likely a ledger or account book. The text is written in a language that appears to be a mix of English and a local language, possibly Hindi or Urdu. The entries are organized into columns, with some numbers and dates visible. The text is written on aged, slightly stained paper.

29  
10  
459  
489  
437  
52

459.08  
 634.00  
 370  
 46912

10

10 21  
 10 42  
 10 21  
 10 21  
 10 21  
 10 21  
 10 21  
 10 21  
 10 20  
 10 42  
 10 40

10 21  
 10 100  
 10 21

4.12  
 10  
 4.22  
 52  
 3.18



1923 10 10/53

*[The handwriting in this section is extremely faint and illegible.]*

11,28  
 12,58  
 24,36

~~117~~ 117

117  
 117  
 117  
 117  
 117  
 117  
 117

117  
 117  
 117  
 117  
 117  
 117  
 117

2	2	2	30
117	117	117	15
117	117	117	30
117	117	117	30
117	117	117	65
			117

12	
x 15	
60	1
120	2
180	



1923

21 April

Dear Sir,  
I have the pleasure to inform you that the  
first of the four volumes of the "History of the  
County of York" has been published and is  
now on sale at the price of \$12.50 per volume.  
The second volume is also in the press and  
will be published in the near future. The third  
and fourth volumes are also in the press and  
will be published in the near future. The  
total cost of the four volumes is \$50.00.  
I am, Sir, very respectfully,  
Your obedient servant,  
J. H. [Name]

2-16-23  
J. H. [Name]





$$\begin{array}{r}
 30 \\
 16.01 \\
 50 \\
 11.10 \\
 310 \\
 \hline
 31.01
 \end{array}$$

$$\begin{array}{r}
 31 \\
 31 \\
 1.00 \\
 31 \\
 30 \\
 \hline
 31 \\
 31 \\
 31 \\
 31 \\
 30
 \end{array}$$

$$\begin{array}{r}
 31.01 \\
 6.50
 \end{array}$$

$$\begin{array}{r}
 30.5
 \end{array}$$

$$\begin{array}{r}
 122 \\
 25 \\
 65
 \end{array}$$

$$\begin{array}{r}
 522 \\
 500 \\
 \hline
 1022
 \end{array}$$

$$\begin{array}{r}
 377 \\
 231 \\
 \hline
 608
 \end{array}$$

$$\begin{array}{r}
 2451 \\
 1022 \\
 \hline
 3473
 \end{array}$$

$$\begin{array}{r}
 500 \\
 \hline
 2973
 \end{array}$$

$$\begin{array}{r}
 69 \\
 2 \\
 150 \\
 65 \\
 65 \\
 65
 \end{array}$$

$$\begin{array}{r}
 15.91 \\
 10 \\
 \hline
 16.01
 \end{array}$$











94135

147.25

1923.2

1923.2

1923.2

1923.2

1923.2

1923.2

1923.2

1923.2

1923.2

1923.2

1923.2

1923.2





[illegible]













245 481

1924

Feb 9

Handwritten text in German script, likely a header or title.

Handwritten text in German script, consisting of several lines of cursive handwriting.

1924.

, 20 Jan

[illegible]



498

6534

20

From 50 to 100

The first number of the series  
 is 498, and the second is 6534.  
 The third is 100, and the fourth is 100.  
 The fifth is 100, and the sixth is 100.  
 The seventh is 100, and the eighth is 100.  
 The ninth is 100, and the tenth is 100.  
 The eleventh is 100, and the twelfth is 100.  
 The thirteenth is 100, and the fourteenth is 100.  
 The fifteenth is 100, and the sixteenth is 100.  
 The seventeenth is 100, and the eighteenth is 100.  
 The nineteenth is 100, and the twentieth is 100.  
 The twenty-first is 100, and the twenty-second is 100.  
 The twenty-third is 100, and the twenty-fourth is 100.  
 The twenty-fifth is 100, and the twenty-sixth is 100.  
 The twenty-seventh is 100, and the twenty-eighth is 100.  
 The twenty-ninth is 100, and the thirtieth is 100.  
 The thirty-first is 100, and the thirty-second is 100.  
 The thirty-third is 100, and the thirty-fourth is 100.  
 The thirty-fifth is 100, and the thirty-sixth is 100.  
 The thirty-seventh is 100, and the thirty-eighth is 100.  
 The thirty-ninth is 100, and the fortieth is 100.  
 The forty-first is 100, and the forty-second is 100.  
 The forty-third is 100, and the forty-fourth is 100.  
 The forty-fifth is 100, and the forty-sixth is 100.  
 The forty-seventh is 100, and the forty-eighth is 100.  
 The forty-ninth is 100, and the fiftieth is 100.  
 The fifty-first is 100, and the fifty-second is 100.  
 The fifty-third is 100, and the fifty-fourth is 100.  
 The fifty-fifth is 100, and the fifty-sixth is 100.  
 The fifty-seventh is 100, and the fifty-eighth is 100.  
 The fifty-ninth is 100, and the sixtieth is 100.  
 The sixty-first is 100, and the sixty-second is 100.  
 The sixty-third is 100, and the sixty-fourth is 100.  
 The sixty-fifth is 100, and the sixty-sixth is 100.  
 The sixty-seventh is 100, and the sixty-eighth is 100.  
 The sixty-ninth is 100, and the seventieth is 100.  
 The seventy-first is 100, and the seventy-second is 100.  
 The seventy-third is 100, and the seventy-fourth is 100.  
 The seventy-fifth is 100, and the seventy-sixth is 100.  
 The seventy-seventh is 100, and the seventy-eighth is 100.  
 The seventy-ninth is 100, and the eightieth is 100.  
 The eighty-first is 100, and the eighty-second is 100.  
 The eighty-third is 100, and the eighty-fourth is 100.  
 The eighty-fifth is 100, and the eighty-sixth is 100.  
 The eighty-seventh is 100, and the eighty-eighth is 100.  
 The eighty-ninth is 100, and the ninetieth is 100.  
 The ninety-first is 100, and the ninety-second is 100.  
 The ninety-third is 100, and the ninety-fourth is 100.  
 The ninety-fifth is 100, and the ninety-sixth is 100.  
 The ninety-seventh is 100, and the ninety-eighth is 100.  
 The ninety-ninth is 100, and the hundredth is 100.

20

211

27 June 1904

[illegible]





[illegible]



931

252. 627254

2048

$$\begin{array}{r} 11 \quad 152 \\ 20 \overline{) 48} \end{array}$$

200048 16, 10 10 0, 9 1/2 1, 12 1/2 10 1/2 10 1/2

1875

was a great deal of rain

10/10/1949

מלכותו יתברך

[illegible]

~~Handwritten scribbles~~

~~Handwritten text, possibly a signature or name, written in a cursive script.~~

Aug 2 1880

17

23 24 25 26 27 28 29 30 31 32 33 34 35 36 37 38 39 40 41 42 43 44 45 46 47 48 49 50 51 52 53 54 55 56 57 58 59 60 61 62 63 64 65 66 67 68 69 70 71 72 73 74 75 76 77 78 79 80 81 82 83 84 85 86 87 88 89 90 91 92 93 94 95 96 97 98 99 100



ה'תר"ל ח' שבט ה'תר"ל

מס' 1414 תר"ל

ה'תר"ל ח' שבט ה'תר"ל

ה'תר"ל ח' שבט ה'תר"ל

ה'תר"ל ח' שבט ה'תר"ל

ה'תר"ל ח' שבט ה'תר"ל

ה'תר"ל ח' שבט ה'תר"ל

ה'תר"ל ח' שבט ה'תר"ל

ה'תר"ל ח' שבט ה'תר"ל

ה'תר"ל ח' שבט ה'תר"ל

ה'תר"ל ח' שבט ה'תר"ל

ה'תר"ל ח' שבט ה'תר"ל

ה'תר"ל ח' שבט ה'תר"ל

ה'תר"ל ח' שבט ה'תר"ל

ה'תר"ל ח' שבט ה'תר"ל

ה'תר"ל ח' שבט ה'תר"ל

ה'תר"ל ח' שבט ה'תר"ל

*[Faint, illegible handwritten text, possibly bleed-through from the reverse side of the page.]*

~~Handwritten scribbles and numbers, possibly representing a cancelled document or signature.~~

*[Faint, illegible handwriting, possibly bleed-through from the reverse side of the page.]*

~~See 2~~





480

420

292

717

[illegible]

Wm. B. Ewing  
New York

750



1925 4 11 12 13 14 15 16 17 18 19 20 21 22 23 24 25 26 27 28 29 30  
 31 32 33 34 35 36 37 38 39 40 41 42 43 44 45 46 47 48 49 50  
 51 52 53 54 55 56 57 58 59 60 61 62 63 64 65 66 67 68 69 70  
 71 72 73 74 75 76 77 78 79 80 81 82 83 84 85 86 87 88 89 90  
 91 92 93 94 95 96 97 98 99 100

101 102 103 104 105 106 107 108 109 110  
 111 112 113 114 115 116 117 118 119 120

121 122 123 124 125 126 127 128 129 130  
 131 132 133 134 135 136 137 138 139 140  
 141 142 143 144 145 146 147 148 149 150

1585

1535

הקדמת המורה

הקדמת המורה	10
הקדמת המורה	20
הקדמת המורה	10
הקדמת המורה	20
הקדמת המורה	10
הקדמת המורה	10
הקדמת המורה	10
הקדמת המורה	10
הקדמת המורה	20
הקדמת המורה	10
הקדמת המורה	10
הקדמת המורה	10
הקדמת המורה	20

20 הקדמת  
10 הקדמת

הקדמת המורה 5  
הקדמת המורה 10  
הקדמת המורה 5  
הקדמת המורה 5

הקדמת המורה 63  
הקדמת המורה 55

הקדמת המורה

הקדמת המורה 8  
הקדמת המורה 81.80  
הקדמת המורה

הקדמת המורה 180

הקדמת המורה 15  
הקדמת המורה 15  
הקדמת המורה 30

הקדמת המורה 150  
הקדמת המורה 110  
הקדמת המורה 250

הקדמת המורה 20  
הקדמת המורה 5  
הקדמת המורה 25

הקדמת המורה 300  
הקדמת המורה 150

הקדמת המורה 365  
הקדמת המורה 150

20 50

20.50



[illegible]







65 Feb 7

65 -21

40 Mar 7

60 Mar 7





25  
60  
350

Handwritten text in a cursive script, likely a ledger or account book. The text is written on aged, yellowed paper and is oriented vertically. It appears to be a list of entries, possibly related to a business or financial record, with some numbers and names visible. The script is dense and difficult to decipher fully, but some words like "Kauf" (buy) and "Kasse" (cash) are discernible. The entries are separated by horizontal lines, suggesting a structured list or table.



925 1000 65 1051

[illegible]



744

बुद्धि विवेक ३० १/१९ ४,४५

14,87

1. הנהגות הנדרשות לכל הנאמנים בבית המדרש  
 2. הנהגות הנדרשות לכל הנאמנים בבית המדרש  
 3. הנהגות הנדרשות לכל הנאמנים בבית המדרש  
 4. הנהגות הנדרשות לכל הנאמנים בבית המדרש  
 5. הנהגות הנדרשות לכל הנאמנים בבית המדרש  
 6. הנהגות הנדרשות לכל הנאמנים בבית המדרש  
 7. הנהגות הנדרשות לכל הנאמנים בבית המדרש  
 8. הנהגות הנדרשות לכל הנאמנים בבית המדרש  
 9. הנהגות הנדרשות לכל הנאמנים בבית המדרש  
 10. הנהגות הנדרשות לכל הנאמנים בבית המדרש

1 1/2 y. 100

8. 1871

1050 २ ०११ ३० १०००

22. 10. 1911

7th Oct

[illegible]

2/28 1550

11-20-10

900200 5/25

1892

104 3/4 1/2 1/4 1/8 1/16 1/32 1/64 1/128 1/256 1/512 1/1024 1/2048 1/4096 1/8192 1/16384 1/32768 1/65536 1/131072 1/262144 1/524288 1/1048576 1/2097152 1/4194304 1/8388608 1/16777216 1/33554432 1/67108864 1/134217728 1/268435456 1/536870912 1/1073741824 1/2147483648 1/4294967296 1/8589934592 1/17179869184 1/34359738368 1/68719476736 1/137438953472 1/274877906944 1/549755813888 1/1099511627776 1/2199023255552 1/4398046511104 1/8796093022208 1/17592186044416 1/35184372088832 1/70368744177664 1/140737488355328 1/281474976710656 1/562949953421312 1/1125899906842624 1/2251799813685248 1/4503599627370496 1/9007199254740992 1/18014398509481984 1/36028797018963968 1/72057594037927936 1/144115188075855872 1/288230376151711744 1/576460752303423488 1/1152921504606846976 1/2305843009213693952 1/4611686018427387904 1/9223372036854775808 1/18446744073709551616 1/36893488147419103232 1/73786976294838206464 1/147573952589676412928 1/295147905179352825856 1/590295810358705651712 1/1180591620717411303424 1/2361183241434822606848 1/4722366482869645213696 1/9444732965739290427392 1/18889465931478580854784 1/37778931862957161709568 1/75557863725914323419136 1/151115727451828646838272 1/302231454903657293676544 1/604462909807314587353088 1/1208925819614629174706176 1/2417851639229258349412352 1/4835703278458516698824704 1/9671406556917033397649408 1/19342813113834066795298816 1/38685626227668133590597632 1/77371252455336267181195264 1/154742504910672534362390528 1/309485009821345068724781056 1/618970019642690137449562112 1/1237940039285380274899124224 1/2475880078570760549798248448 1/4951760157141521099596496896 1/9903520314283042199192993792 1/19807040628566084398385987584 1/39614081257132168796771975168 1/79228162514264337593543950336 1/158456325028528675187087900672 1/316912650057057350374175801344 1/633825300114114700748351602688 1/1267650600228229401496703205376 1/2535301200456458802993406410752 1/5070602400912917605986812821504 1/10141204801825835211973625643008 1/20282409603651670423947251286016 1/40564819207303340847894502572032 1/81129638414606681695789005144064 1/162259276829213363391578010288128 1/324518553658426726783156020576256 1/649037107316853453566312041152512 1/1298074214633706907132624082305024 1/2596148429267413814265248164610048 1/5192296858534827628530496329220096 1/10384593717069655257060992658440192 1/20769187434139310514121985316880384 1/41538374868278621028243970633760768 1/83076749736557242056487941267521536 1/166153499473114484112975882535043072 1/332306998946228968225951765070086144 1/664613997892457936451903530140172288 1/1329227995784915872903807060280344576 1/2658455991569831745807614120560689152 1/5316911983139663491615228241121378304 1/10633823966279326983230456482242756608 1/21267647932558653966460912964485513216 1/42535295865117307932921825928971026432 1/85070591730234615865843651857942052864 1/170141183460469231731687303715884105728 1/340282366920938463463374607431768211456 1/680564733841876926926749214863536422912 1/1361129467683753853853498429727072845824 1/2722258935367507707706996859454145691648 1/5444517870735015415413993718908291383296 1/10889035741470030830827987437816582766592 1/21778071482940061661655974875633165533184 1/43556142965880123323311949751266331066368 1/87112285931760246646623899502532662132736 1/174224571863520493293247799005065324265472 1/348449143727040986586495598010130648530944 1/696898287454081973172991196020261297061888 1/1393796574908163946345982392040522594123776 1/2787593149816327892691964784081045188247552 1/5575186299632655785383929568162090376495104 1/11150372599265311570767859136324180752990208 1/22300745198530623141535718272648361505980416 1/44601490397061246283071436545296723011960832 1/89202980794122492566142873090593446023921664 1/178405961588244985132285746181186892047843328 1/356811923176489970264571492362373784095686656 1/713623846352979940529142984724747568191373312 1/1427247692705959881058285969449495136382746624 1/2854495385411919762116571938898990272765493248 1/5708990770823839524233143877797980545530986496 1/11417981541647679048466287755595961091061972992 1/2

1.000  
 2.000  
 3.000  
 4.000  
 5.000  
 6.000  
 7.000  
 8.000  
 9.000  
 10.000  
 11.000  
 12.000  
 13.000  
 14.000  
 15.000  
 16.000  
 17.000  
 18.000  
 19.000  
 20.000  
 21.000  
 22.000  
 23.000  
 24.000  
 25.000  
 26.000  
 27.000  
 28.000  
 29.000  
 30.000  
 31.000  
 32.000  
 33.000  
 34.000  
 35.000  
 36.000  
 37.000  
 38.000  
 39.000  
 40.000  
 41.000  
 42.000  
 43.000  
 44.000  
 45.000  
 46.000  
 47.000  
 48.000  
 49.000  
 50.000  
 51.000  
 52.000  
 53.000  
 54.000  
 55.000  
 56.000  
 57.000  
 58.000  
 59.000  
 60.000  
 61.000  
 62.000  
 63.000  
 64.000  
 65.000  
 66.000  
 67.000  
 68.000  
 69.000  
 70.000  
 71.000  
 72.000  
 73.000  
 74.000  
 75.000  
 76.000  
 77.000  
 78.000  
 79.000  
 80.000  
 81.000  
 82.000  
 83.000  
 84.000  
 85.000  
 86.000  
 87.000  
 88.000  
 89.000  
 90.000  
 91.000  
 92.000  
 93.000  
 94.000  
 95.000  
 96.000  
 97.000  
 98.000  
 99.000  
 100.000

12/11 20 11/11 20 11/11 20  
 12/11 20 11/11 20 11/11 20



by 7.15)

9.72

to the ...

... 1926 ...

... of ...

... of ...

... of ...

... of ...

... of ...





14. 5. 1946

21.46

20. 1. 1946

Handwritten text in a cursive script, likely a diary or journal entry, covering the majority of the page.





செய்து கொடுத்திருக்கிறார்கள்  
மேலும் கொடுத்திருக்கிறார்கள்  
மேலும் கொடுத்திருக்கிறார்கள்









8. 214  
80

180  
 181  
 182  
 183  
 184  
 185  
 186  
 187  
 188  
 189  
 190  
 191  
 192  
 193  
 194  
 195  
 196  
 197  
 198  
 199  
 200

[illegible]



935

Handwritten text in a cursive script, likely a mix of English and another language, possibly German or Dutch. The text is written on lined paper and includes phrases such as "I have", "the", "of", "and", "in", "at", "on", "from", "to", "by", "with", "without", "under", "above", "below", "between", "among", "against", "towards", "from", "to", "by", "with", "without", "under", "above", "below", "between", "among", "against", "towards".

Handwritten text, possibly a date or a reference number, including the number "248".

Handwritten text in a cursive script, likely a letter or a list, written on aged, yellowed paper. The text is arranged in several lines, with some words appearing to be repeated or corrected. The script is dense and somewhat difficult to decipher due to the cursive style and the age of the document. The text appears to be a list of names or places, possibly related to a historical record or a personal account. The words are written in a fluid, connected manner, with some variations in ink color and line thickness. The overall appearance is that of a handwritten manuscript from the 18th or 19th century.



10 51 11.36

11.36

65

150

Handwritten text in a cursive script, likely a ledger or account book. The text is written in a single column and appears to be a list of entries, possibly related to a business or financial record. The script is dense and difficult to decipher, but it seems to contain numbers and descriptive phrases. The entries are written in a cursive script, likely a form of shorthand or a specific dialect. The text is written in a single column and appears to be a list of entries, possibly related to a business or financial record. The script is dense and difficult to decipher, but it seems to contain numbers and descriptive phrases. The entries are written in a cursive script, likely a form of shorthand or a specific dialect. The text is written in a single column and appears to be a list of entries, possibly related to a business or financial record. The script is dense and difficult to decipher, but it seems to contain numbers and descriptive phrases.



Handwritten text in a cursive script, likely a mix of English and Hebrew. The text is written on lined paper and includes phrases such as "I have been thinking of you", "I am very happy", and "I am very well".





[illegible]









מחיר	30-
מחיר	40-
מחיר	38-
מחיר	39-
מחיר	4-
מחיר	14-
מחיר	37-
מחיר	16-
מחיר	34-
מחיר	31-
מחיר	33-
מחיר	32-
מחיר	12-
מחיר	25-
מחיר	18-

מחיר	10-
מחיר	2-
מחיר	17-
מחיר	4-
מחיר	26-
מחיר	36-
מחיר	21-
מחיר	20-
מחיר	28-
מחיר	27-
מחיר	29-
מחיר	19-
מחיר	24-
מחיר	23-





25  
 22  
 50  
 50  
 550  
 125  
 6.75

25  
 18 1/2 36  
 18 1/2 21  
 18 1/2 20-  
 2 1/2 28

10 1/2  
 2 1/2  
 1 1/2  
 7  
 4 1/2

23  
 19  
 24  
 27  
 16

22  
 20 1/2 12

3  
 10  
 12  
 10  
 12

1926 1968 1970

Jan 15 30

12. 12. 13

[illegible]

Г'д 2 г'д 26

2181 1.2 2111 3

Sept 5

259159 14

१४

14



1st  
1st  
2nd  
3rd

2

1

1-

1st

1-

3-

1-

1-

2-

4-

פער גוט

200 פער גוט

125 פער

20 פער

12 פער

5 פער

---

פער זיכער

40 פער

20 פער

2 פער

---

פער

25 פער

20 פער

6 פער



1926. 8. 26

1. 12  
 + 1. 15 2-  
 2. 15 1-  
 3. 15 1-  
 4. 15 18-  
 5. 15 1-  
 6. 15 3-

1. 12  
 2. 15 3-  
 3. 15 1-  
 4. 15 1-  
 5. 15 1-  
 6. 15 1-

1. 15 10  
 2. 15 18  
 3. 15 5  
 4. 15 1-  
 5. 15 2-  
 6. 15 2-

1. 15 3-  
 2. 15 3-  
 3. 15 4-  
 4. 15 1-  
 5. 15 1-  
 6. 15 1-

1. 15 3-  
 2. 15 2-  
 3. 15 2-  
 4. 15 1-  
 5. 15 1-  
 6. 15 1-

giml bair abf

11 D X f P 2, 6 n 1 2 3 2 10.  
nl 2 P 4 3 f 5 5 2 2

tes ches zaim var hey daled giml bair abf

6 n 3 1 2 2 2 2 10

langer-nun schlos-mem lanned, langer-chof-ud

1 langer-chadied langer-fay pay ien same  
f 3 f 5 5 2 2 0

raize kub  
2 P



This is a round pillbox. Grosgrain, <sup>tiny</sup> bows  
 on both sides. Left one holds the veil,  
 as shown in fig. 1. Or, like fig. 2, both  
 bows hold the veil. Gathering at the  
 top make it large enough to come  
 wide a part. Hook & like  
 dots holds

both together.

Mr. Blue, Gold,  
 Black, Brown,  
 Wine. Straw  
 or felt. Liger

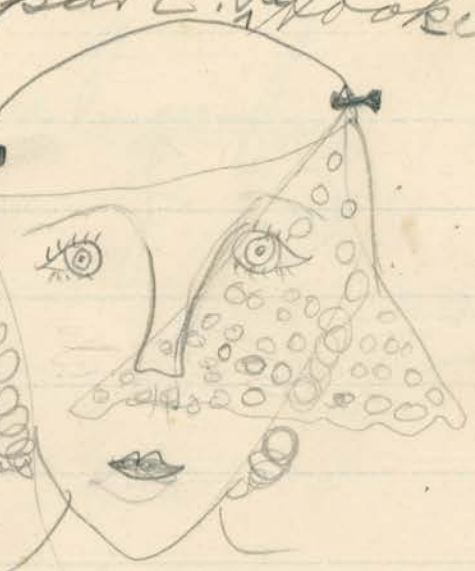

Fig. 1



Fig. 2

21-23.

No. 2000

$$\begin{array}{r}
 1 \\
 \hline
 5 \\
 \hline
 4 \\
 \hline
 0 \\
 \hline
 1 \\
 \hline
 2 \\
 \hline
 1 \\
 \hline
 4
 \end{array}$$

$$\begin{array}{r}
 5 \\
 \hline
 1 \\
 \hline
 2 \\
 \hline
 4 \\
 \hline
 2 \\
 \hline
 5 \\
 \hline
 3
 \end{array}$$

$$\begin{array}{r}
 4 \\
 \hline
 1 \\
 \hline
 0 \\
 \hline
 7 \\
 \hline
 4 \\
 \hline
 6 \\
 \hline
 2 \\
 \hline
 8
 \end{array}$$

$$\begin{array}{r}
 5 \\
 \hline
 1 \\
 \hline
 3 \\
 \hline
 1 \\
 \hline
 3 \\
 \hline
 4 \\
 \hline
 0 \\
 \hline
 4
 \end{array}$$

$$\begin{array}{r}
 2 \\
 \hline
 2 \\
 \hline
 3 \\
 \hline
 5 \\
 \hline
 0 \\
 \hline
 5 \\
 \hline
 7 \\
 \hline
 2 \\
 \hline
 4 \\
 \hline
 8 \\
 \hline
 3 \\
 \hline
 3
 \end{array}$$

10 Minut



Books



School Stuff



Erasen

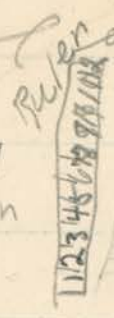

76

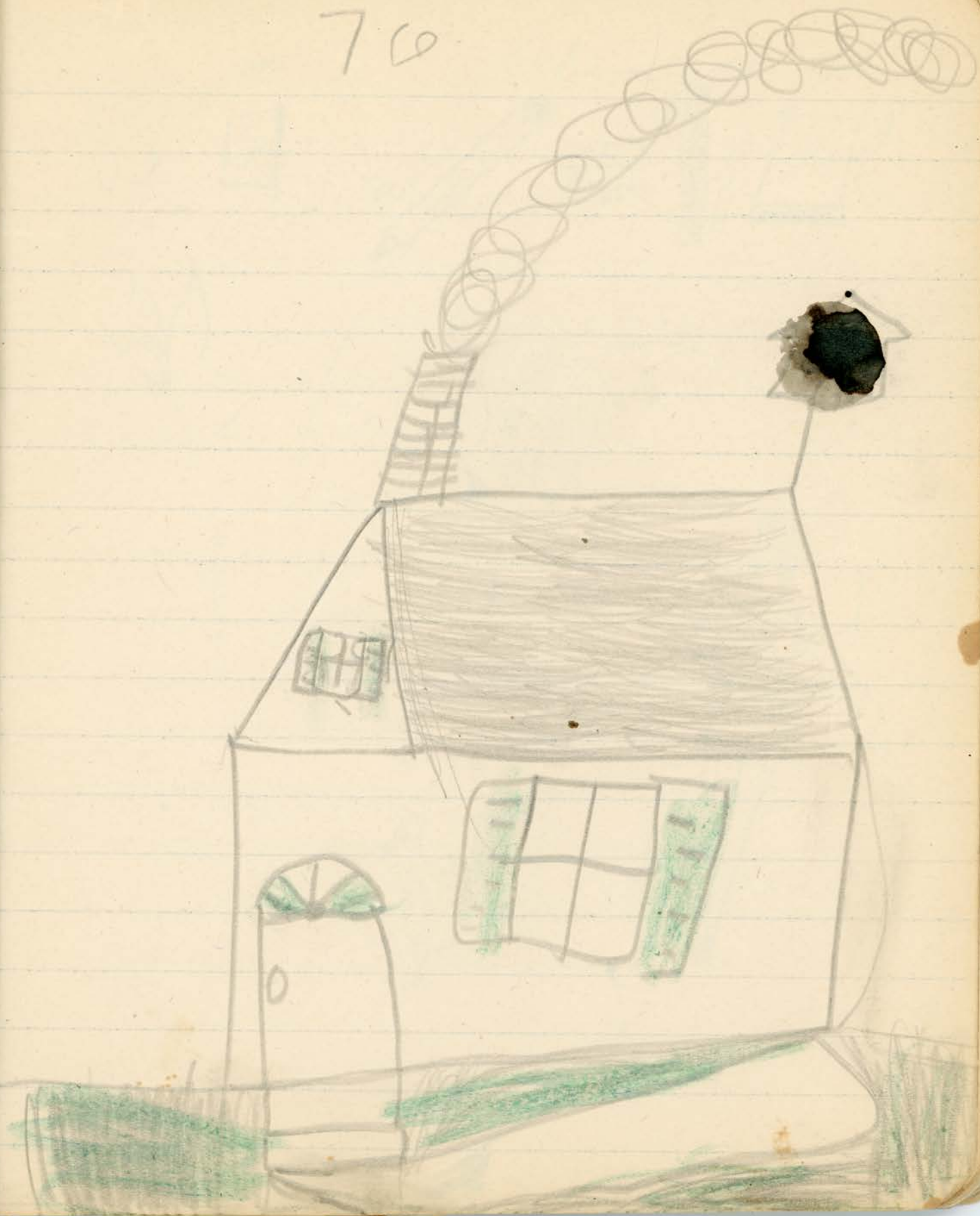



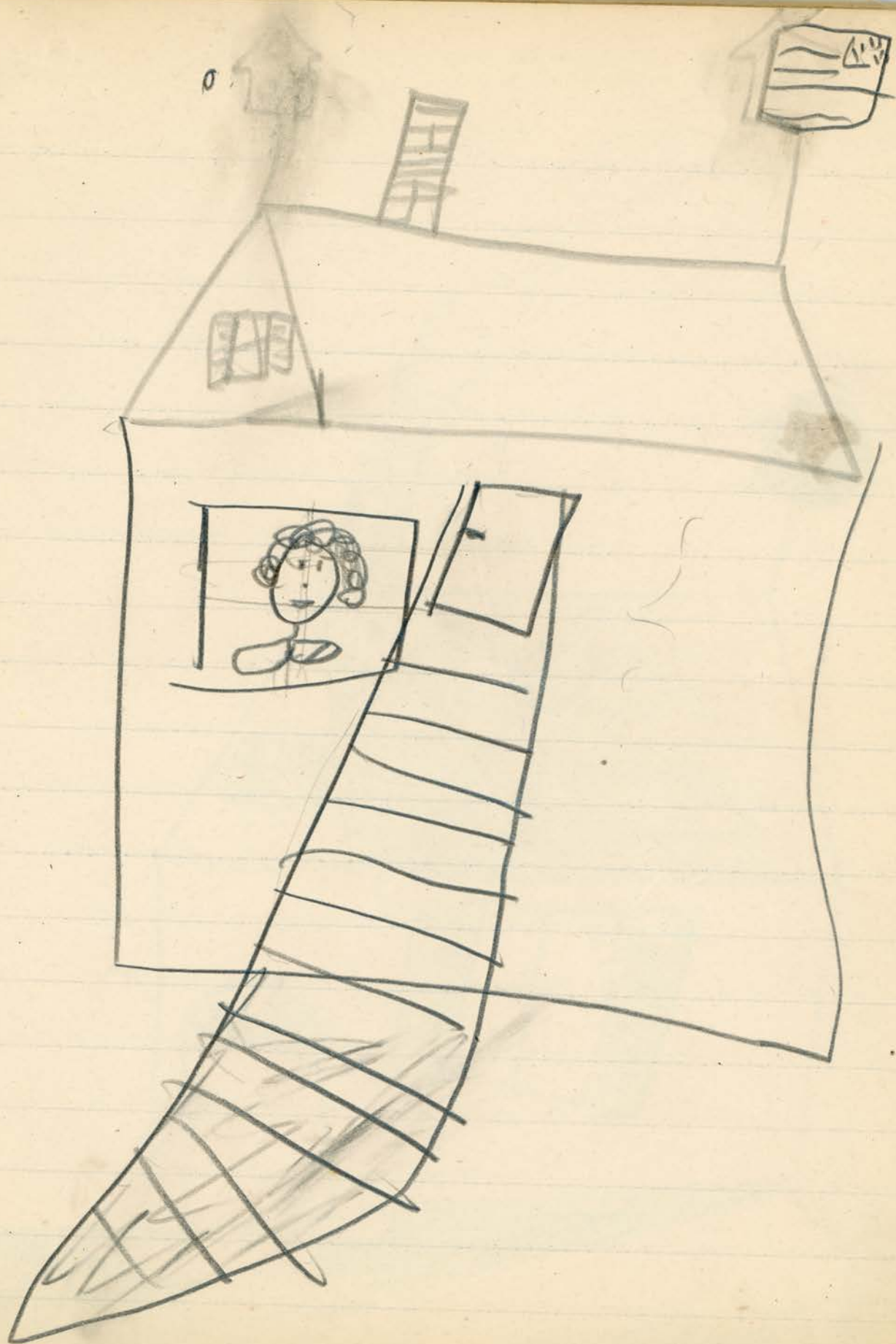

Case 49261

1/2  
 1/4  
 3-  
 1-  
 1/2

3-  
 1/2-  
 1-  
 1/2-

1-  
 3-  
 1-  
 2-  
 1/2-  
 2-

1-  
 2-  
 2-  
 1-  
 4-

1-  
 1-  
 1-  
 3-  
 2-

5-  
 1-  
 1-  
 1/2-  
 2-  
 3-



754 ~~1926~~  
 1926

1926 2/26/20

1926

Gallin  
 2 1/2 15  
 1 1/2 15  
 1 1/2 2  
 1 1/2 1  
 1 1/2  
 1 1/2  
 1 1/2

2 1/2 15  
 1 1/2 15  
 1 1/2 2  
 1 1/2 1

1 1/2 15  
 1 1/2 15  
 1 1/2 5  
 1 1/2 1

1 1/2  
 1 1/2  
 1 1/2

2 1/2 15  
 1 1/2 10  
 1 1/2 3  
 1 1/2 1/2

1 1/2 15  
 1 1/2 15  
 1 1/2 10  
 1 1/2 1

1 1/2 10  
 1 1/2 5  
 1 1/2 5  
 1 1/2 1  
 1 1/2 2

Gallin  
 2 1/2 15  
 1 1/2 10  
 1 1/2 2

1 1/2 10  
 1 1/2 5

1 1/2 15  
 1 1/2 10  
 1 1/2 1  
 1 1/2 1/2  
 1 1/2 3





10  
 5  
 1  
 2

2  
 20  
 10  
 1

5  
 5  
 2  
 1

2  
 35  
 15  
 3

2  
 10  
 5  
 2  
 2

10  
 10  
 1

2  
 20  
 20  
 20

10  
 5  
 2  
 2

12

1966

94

1924, 14 Jan 1924

5  
Conf 40

— 20

30

2. The Earl  
of  
Glen  
Glen

\_\_\_\_\_

22.10.72

30

१११/० १

30

65

23.6 14

1018 65

Sept 15

Aug 20

30 June

22. 10 7

50

50

25

16

521

52  
290

8,64

30

-30

30

30

30

30

50

30

30

290

ms 268 61

1556. 62

10 5 7 8 9

30

W. H. J. 178



26/11/90

22nd Nov 23 1924

21. *Phragmites*

Ms. B. 50

21

2010 2

21

21.02.24 J. Th. A. D.

42

21

Aug 35 to Sep 65 21

21 7850, 1190798

20

140607 65 42 7/120 202

200  
21  
21  
21  
21  
42

$\begin{array}{r} 708 \\ 714 \\ \hline 722 \end{array}$

*(Faint handwritten numbers at bottom)*

14 15 16 17 18 19 20 21 22 23 24 25 26 27 28 29 30 31 32 33 34 35 36 37 38 39 40 41 42 43 44 45 46 47 48 49 50 51 52 53 54 55 56 57 58 59 60 61 62 63 64 65 66 67 68 69 70 71 72 73 74 75 76 77 78 79 80 81 82 83 84 85 86 87 88 89 90 91 92 93 94 95 96 97 98 99 100

86

4/9

2/9

5/8

9/4/8

3

1/5

1/5

1/5

1/5

1/5

1/5

1/5

1/5

946

1096

150

21

1096

1117

1/5

50

21

21

21

21

21

21

21

21

21

21

21

21

21

21

21

21

21

21

21

1/5

1/5

1/5

1/5

1/5

1/5

1/5

1/5

1/5

1/5

1/5

1/5

1/5

1/5

1/5

1/5

1/5

1/5

1/5

1/5

6.8

65

21

4.9



35  
 15  
 2

---

35  
 15  
 2

---

15  
 10

---

3

---

10  
 10  
 1

---

25  
 15  
 3

---

5  
 5  
 2

---

8  
 5

---

5  
 5  
 2

---





S.C. 114-

и обр -

2

for 1

1000

$$2-2=0$$

מספר י. סוף

מספר 10  
מספר 5  
מספר 2

מספר 10

מספר 10

מספר 3

מספר 1

מספר 2

מספר 3

מספר 10

מספר 5

מספר 2

מספר 1

מספר 1

מספר 15

מספר 5

מספר 1

מספר 1

מספר סוף

מספר 20

מספר 10

מספר 2

מספר 1

מספר 10

מספר 1

מספר 14

מספר 1

מספר 2

מספר 3

מספר 3

מספר סוף

מספר 15

מספר 10

מספר 5

מספר 1

מספר 1

מספר 1



גריס סעמ

גריס 4

גריס 2

גריס 2

גריס 1

גריס 3 גריס 2

1 גריס 15

גריס 10

גריס סעמ

גריס 35

גריס 10

גריס 5

גריס סעמ

A.C. 14

גריס 2, גריס 1

גריס 2

גריס 1

גריס 5

גריס סעמ

גריס 250

גריס 165

גריס 15

גריס 27

גריס 6

גריס 35

גריס 30

גריס 12

גריס 11

גריס 6

גריס 15

גריס 15

גריס 18

גריס 2

גריס 1

גריס 1

גריס סעמ

85 גריס

35 גריס

5 גריס

2 גריס

5 1/2 lbs of mints  
5 " flour

2 ginger

1 cinnamon

~~2 1/2 lbs of prunes.~~

~~2 1/2 lbs of H. saddish~~

~~2 lbs of cake flour~~

~~2 1/2 lbs of tea~~

~~5000 500 10~~

~~5000 500 3~~

~~P. Schudtz~~



1 the present office

1 the 2nd

1 the 3rd

2 the 4th

2 the 5th

1 the 6th

1 the 7th

1330

~~16~~ 20

11/18/18  
J.H. Duro

George  
H. Smith  
phil

10/18/18

1/18

76

2/18/18 1  
2/18/18 2  
2/18/18 2  
2/18/18 2  
2/18/18 1

787

2130  
598

1522

1/18/18  
2/18/18  
3/18/18

~~1/18/18~~  
~~2/18/18~~

1/18/18  
2/18/18  
3/18/18

375  
1698

1/18/18  
2/18/18  
3/18/18

4/18/18  
5/18/18  
6/18/18

Page 20



*Given by Ads to All*

COMPOSITIONS

W-B 690



459.08 June 14

1923 24 153

Handwritten text in a cursive script, likely a ledger or account book. The text is written in a language that appears to be a mix of English and a local dialect, possibly from the Pacific Northwest. The entries are organized into columns, with some lines crossed out. The text is written on aged, slightly stained paper.

29  
10  
459  
489  
437  
52



459.08

634.00

370

46912

100 21

100 42

100 21

100 21

100 21

100 21

100 21

100 20

100 42

100 40

210

100 21

100 100

100 21

412

10

422

52

318

1923 10 10/53

[illegible]

11,28  
 12,58  
 24,36



~~117~~ 118

2  
 117  
 118  
 119  
 120  
 121  
 122  
 123  
 124  
 125  
 126  
 127  
 128  
 129  
 130

131  
 132  
 133  
 134  
 135  
 136  
 137  
 138  
 139  
 140  
 141  
 142  
 143  
 144  
 145  
 146  
 147  
 148  
 149  
 150

2	2	2	30
117	118	119	15
120	121	122	30
123	124	125	30
126	127	128	65
			140

12	
x 15	13
60	2
120	
180	

1923

21 April

Dear Sir,  
I have the pleasure to inform you that the  
first of the four volumes of the "History of the  
County of York" has been published and is now  
available for sale. The price of the volume is  
\$12.50. The second volume is also in the  
press and will be published in the near future.  
The third and fourth volumes are also in the  
press and will be published in the near future.  
I am, Sir, very respectfully,  
Your obedient servant,  
J. H. [Name]

2-16-23  
J. H. [Name]



1923 16

1923 16  
The following list of names  
is given for the year 1923  
The names are given in the  
order in which they were  
received, 16, 62, 1923  
The names are given in the  
order in which they were  
received, 16, 62, 1923  
The names are given in the  
order in which they were  
received, 16, 62, 1923

$$\begin{array}{r}
 30 \\
 16.01 \\
 50 \\
 11.10 \\
 310 \\
 \hline
 31.01
 \end{array}$$

$$\begin{array}{r}
 31 \\
 31 \\
 31 \\
 1.00 \\
 31 \\
 30 \\
 ~~31~~ \\
 31 \\
 31 \\
 31 \\
 31 \\
 30
 \end{array}$$

$$\begin{array}{r}
 31.01 \\
 6.50
 \end{array}$$

$$\begin{array}{r}
 24.51 \\
 10.22 \\
 \hline
 34.73
 \end{array}$$

$$\begin{array}{r}
 34.73 \\
 5.00 \\
 \hline
 39.73
 \end{array}$$

$$\begin{array}{r}
 29.73
 \end{array}$$

$$\begin{array}{r}
 69 \\
 2 \\
 150 \\
 65 \\
 65 \\
 65
 \end{array}$$

$$\begin{array}{r}
 15.91 \\
 10 \\
 \hline
 16.01
 \end{array}$$

30.5

122

25

65

522

500

10.22









19236 202 m. W. of

10 11 12 13 14 15 16 17 18 19 20 21 22 23 24 25 26 27 28 29 30 31 32 33 34 35 36 37 38 39 40 41 42 43 44 45 46 47 48 49 50 51 52 53 54 55 56 57 58 59 60 61 62 63 64 65 66 67 68 69 70 71 72 73 74 75 76 77 78 79 80 81 82 83 84 85 86 87 88 89 90 91 92 93 94 95 96 97 98 99 100

94135

147.25

1923.2

1923.2

1923.2

1923.2

1923.2

1923.2

1923.2

1923.2

1923.2

1923.2

1923.2

1923.2





[illegible]













245 481  
1874

1924

Handwritten text in German script, likely a header or title.

Handwritten text in German script, consisting of several lines of cursive handwriting.



1924.

, 20 Jan

[illegible]





211

27 June 1904

[illegible]





[illegible]

931

252. 627254

2048

$$\begin{array}{r} 11 \quad 12 \\ 20 \overline{) 2048} \end{array}$$

$\frac{1}{x^2} = x^{-2}$

1875

was in fact a great deal of rain

9 April 1867

וְהָיָה כִּי יֵרָאֶה הַבְּנֵי יִשְׂרָאֵל אֶת-עֲמֹנִית וְאֶת-מוֹאָבִית

2004 3/1 100 9

~~10/20/95~~ 2nd March 1892 G.S.

Handwritten text: *Handwritten text, possibly a signature or name, written in cursive script.*

Aug 2, 1880

17/4



23 24 25 26 27 28 29 30 31 32 33 34 35 36 37 38 39 40 41 42 43 44 45 46 47 48 49 50 51 52 53 54 55 56 57 58 59 60 61 62 63 64 65 66 67 68 69 70 71 72 73 74 75 76 77 78 79 80 81 82 83 84 85 86 87 88 89 90 91 92 93 94 95 96 97 98 99 100



ה'תר"ל ח' שבט ה'תר"ל

מס' 1414 תר"ל

ה'תר"ל ח' שבט ה'תר"ל

ה'תר"ל ח' שבט ה'תר"ל

ה'תר"ל ח' שבט ה'תר"ל

ה'תר"ל ח' שבט ה'תר"ל

ה'תר"ל ח' שבט ה'תר"ל

ה'תר"ל ח' שבט ה'תר"ל

ה'תר"ל ח' שבט ה'תר"ל

ה'תר"ל ח' שבט ה'תר"ל

ה'תר"ל ח' שבט ה'תר"ל

ה'תר"ל ח' שבט ה'תר"ל

ה'תר"ל ח' שבט ה'תר"ל

ה'תר"ל ח' שבט ה'תר"ל

ה'תר"ל ח' שבט ה'תר"ל

ה'תר"ל ח' שבט ה'תר"ל



*[Faint, illegible handwritten text, possibly bleed-through from the reverse side of the page.]*

~~Handwritten scribbles and numbers, possibly representing calculations or dates.~~

*[Faint, illegible handwriting, possibly bleed-through from the reverse side of the page.]*

~~See 2~~

agreement  
family prof  
Grob 9/14/14.

[illegible]



480

420

292

717

[illegible]

Wm. B. Ewing, Esq.  
New York

750

1000 of 10000

~~4 126 2 1/2 9 1000~~  
 800 7 106 2 1/2 9 1000  
 01/8 1/10



155

1535

1870

10  
20

101

20  
10

10 - 10

9, 11, 12, 13, 14, 15, 16, 17, 18, 19, 20, 21, 22, 23, 24, 25, 26, 27, 28, 29, 30, 31, 32, 33, 34, 35, 36, 37, 38, 39, 40, 41, 42, 43, 44, 45, 46, 47, 48, 49, 50, 51, 52, 53, 54, 55, 56, 57, 58, 59, 60, 61, 62, 63, 64, 65, 66, 67, 68, 69, 70, 71, 72, 73, 74, 75, 76, 77, 78, 79, 80, 81, 82, 83, 84, 85, 86, 87, 88, 89, 90, 91, 92, 93, 94, 95, 96, 97, 98, 99, 100, 101, 102, 103, 104, 105, 106, 107, 108, 109, 110, 111, 112, 113, 114, 115, 116, 117, 118, 119, 120, 121, 122, 123, 124, 125, 126, 127, 128, 129, 130, 131, 132, 133, 134, 135, 136, 137, 138, 139, 140, 141, 142, 143, 144, 145, 146, 147, 148, 149, 150, 151, 152, 153, 154, 155, 156, 157, 158, 159, 160, 161, 162, 163, 164, 165, 166, 167, 168, 169, 170, 171, 172, 173, 174, 175, 176, 177, 178, 179, 180, 181, 182, 183, 184, 185, 186, 187, 188, 189, 190, 191, 192, 193, 194, 195, 196, 197, 198, 199, 200, 201, 202, 203, 204, 205, 206, 207, 208, 209, 210, 211, 212, 213, 214, 215, 216, 217, 218, 219, 220, 221, 222, 223, 224, 225, 226, 227, 228, 229, 230, 231, 232, 233, 234, 235, 236, 237, 238, 239, 240, 241, 242, 243, 244, 245, 246, 247, 248, 249, 250, 251, 252, 253, 254, 255, 256, 257, 258, 259, 260, 261, 262, 263, 264, 265, 266, 267, 268, 269, 270, 271, 272, 273, 274, 275, 276, 277, 278, 279, 280, 281, 282, 283, 284, 285, 286, 287, 288, 289, 290, 291, 292, 293, 294, 295, 296, 297, 298, 299, 300, 301, 302, 303, 304, 305, 306, 307, 308, 309, 310, 311, 312, 313, 314, 315, 316, 317, 318, 319, 320, 321, 322, 323, 324, 325, 326, 327, 328, 329, 330, 331, 332, 333, 334, 335, 336, 337, 338, 339, 340, 341, 342, 343, 344, 345, 346, 347, 348, 349, 350, 351, 352, 353, 354, 355, 356, 357, 358, 359, 360, 361, 362, 363, 364, 365, 366, 367, 368, 369, 370, 371, 372, 373, 374, 375, 376, 377, 378, 379, 380, 381, 382, 383, 384, 385, 386, 387, 388, 389, 390, 391, 392, 393, 394, 395, 396, 397, 398, 399, 400, 401, 402, 403, 404, 405, 406, 407, 408, 409, 410, 411, 412, 413, 414, 415, 416, 417, 418, 419, 420, 421, 422, 423, 424, 425, 426, 427, 428, 429, 430, 431, 432, 433, 434, 435, 436, 437, 438, 439, 440, 441, 442, 443, 444, 445, 446, 447, 448, 449, 450, 451, 452, 453, 454, 455, 456, 457, 458, 459, 460, 461, 462, 463, 464, 465, 466, 467, 468, 469, 470, 471, 472, 473, 474, 475, 476, 477, 478, 479, 480, 481, 482, 483, 484, 485, 486, 487, 488, 489, 490, 491, 492, 493, 494, 495, 496, 497, 498, 499, 500, 501, 502, 503, 504, 505, 506, 507, 508, 509, 510, 511, 512, 513, 514, 515, 516, 517, 518, 519, 520, 521, 522, 523, 524, 525, 526, 527, 528, 529, 530, 531, 532, 533, 534, 535, 536, 537, 538, 539, 540, 541, 542, 543, 544, 545, 546, 547, 548, 549, 550, 551, 552, 553, 554, 555, 556, 557, 558, 559, 560, 561, 562, 563, 564, 565, 566, 567, 568, 569, 570, 571, 572, 573, 574, 575, 576, 577, 578, 579, 580, 581, 582, 583, 584, 585, 586, 587, 588, 589, 590, 591, 592, 593, 594, 595, 596, 597, 598, 599, 600, 601, 602, 603, 604, 605, 606, 607, 608, 609, 610, 611, 612, 613, 614, 615, 616, 617, 618, 619, 620, 621, 622, 623, 624, 625, 626, 627, 628, 629, 630, 631, 632, 633, 634, 635, 636, 637, 638, 639, 640, 641, 642, 643, 644, 645, 646, 647, 648, 649, 650, 651, 652, 653, 654, 655, 656, 657, 658, 659, 660, 661, 662, 663, 664, 665, 666, 667, 668, 669, 670, 671, 672, 673, 674, 675, 676, 677, 678, 679, 680, 681, 682, 683, 684, 685, 686, 687, 688, 689, 690, 691, 692, 693, 694, 695, 696, 697, 698, 699, 700, 701, 702, 703, 704, 705, 706, 707, 708, 709, 710, 711, 712, 713, 714, 715, 716, 717, 718, 719, 720, 721, 722, 723, 724, 725, 726, 727, 728, 729, 730, 731, 732, 733, 734, 735, 736, 737, 738, 739, 740, 741, 742, 743, 744, 745, 746, 747, 748, 749, 750, 751, 752, 753, 754, 755, 756, 757, 758, 759, 760, 761, 762, 763, 764, 765, 766, 767, 768, 769, 770, 771, 772, 773, 774, 775, 776, 777, 778, 779, 780, 781, 782, 783, 784, 785, 786, 787, 788, 789, 790, 791, 792, 793, 794, 795, 796, 797, 798, 799, 800, 801, 802, 803, 804, 805, 806, 807, 808, 809, 810, 811, 812, 813, 814, 815, 816, 817, 818, 819, 820, 821, 822, 823, 824, 825, 826, 827, 828, 829, 830, 831, 832, 833, 834, 835, 836, 837, 838, 839, 840, 841, 842, 843, 844, 845, 846,

for ~~1000~~ 10 10  
90

20  
10

17. 100, 2 10

10 10

1-10

for 20

20. 1887

10

Aug. 6 5 / 1861

1890, 10, 10

g. No

~~12/21/21~~ 5

~~067.6 / 65.1.15 63~~  
~~15.1.15 3 55~~

[illegible]

July 180

ବୃଷାବଦ 15

15

11/2/20 30

05/Jul 1897 p 13

Calliope

Full 28 Oct 1900

rd. 0.250

100 100 100 100 100

5/11/82

1000 25

1852 Oct 3.00

150

1894

365

Q. 110 150

90 50

90 17



[illegible]





65 Feb 7

65 -21

40 Mar 7

60 Mar 7



[illegible]



25  
60  
350

Handwritten text in a cursive script, likely a ledger or account book. The text is written on aged, yellowed paper and is oriented vertically. It appears to be a list of entries, possibly related to a business or financial record, with some numbers and names visible. The script is dense and somewhat difficult to decipher due to its cursive nature and the age of the document.



925 1000 65 1051

[illegible]



744

बुद्धि विवेक ३४ १/१९ ४,४५

14,87

[illegible]





by 7.15)

29.9.72

to the ...

...

...

...

...

...

...







14. 5. 1946

21.46

20. 1. 1946

Handwritten text in a script, likely Indic, covering the main body of the page. The text is written in a cursive style and appears to be a continuous narrative or record.



~~There are~~ 2 canals, the first  
 runs from the river to the  
 mill, the second from the  
 mill to the river, and the  
 third from the river to the  
 river.

The first canal is 1000  
 feet long, the second is 500  
 feet long, and the third is 200  
 feet long.

1868 Jan 19

செய்து கொடுத்திருக்கிறார்கள்  
மேலும் கொடுத்திருக்கிறார்கள்  
மேலும் கொடுத்திருக்கிறார்கள்



3100 1000 8/16

466

Handwritten text in Odia script, likely a letter or document, written on aged paper. The text is dense and covers most of the page.







8. 214  
80

180  
 181  
 182  
 183  
 184  
 185  
 186  
 187  
 188  
 189  
 190  
 191  
 192  
 193  
 194  
 195  
 196  
 197  
 198  
 199  
 200

[illegible]

935

Handwritten text in a cursive script, likely a mix of English and another language, possibly German or Dutch. The text is written on lined paper and includes phrases such as "I have", "I am", and "I will".

Handwritten text, possibly a date or a reference number, including the number "248".



*[Handwritten notes in Devanagari script, likely bleed-through from the reverse side of the page.]*



67.6 35 01.9 10 51

1136

2/10/65

~~62/6150~~

40  
 41  
 42  
 43  
 44  
 45  
 46  
 47  
 48  
 49  
 50  
 51  
 52  
 53  
 54  
 55  
 56  
 57  
 58  
 59  
 60  
 61  
 62  
 63  
 64  
 65  
 66  
 67  
 68  
 69  
 70  
 71  
 72  
 73  
 74  
 75  
 76  
 77  
 78  
 79  
 80  
 81  
 82  
 83  
 84  
 85  
 86  
 87  
 88  
 89  
 90  
 91  
 92  
 93  
 94  
 95  
 96  
 97  
 98  
 99  
 100



Handwritten text in a cursive script, likely a mix of English and Hebrew. The text is written on lined paper and includes phrases such as "I have been thinking of you", "I am very happy", and "I hope you are well".







1911/12  
 1912/13  
 1913/14  
 1914/15  
 1915/16  
 1916/17  
 1917/18  
 1918/19  
 1919/20  
 1920/21  
 1921/22  
 1922/23  
 1923/24  
 1924/25  
 1925/26  
 1926/27  
 1927/28  
 1928/29  
 1929/30  
 1930/31  
 1931/32  
 1932/33  
 1933/34  
 1934/35  
 1935/36  
 1936/37  
 1937/38  
 1938/39  
 1939/40  
 1940/41  
 1941/42  
 1942/43  
 1943/44  
 1944/45  
 1945/46  
 1946/47  
 1947/48  
 1948/49  
 1949/50  
 1950/51  
 1951/52  
 1952/53  
 1953/54  
 1954/55  
 1955/56  
 1956/57  
 1957/58  
 1958/59  
 1959/60  
 1960/61  
 1961/62  
 1962/63  
 1963/64  
 1964/65  
 1965/66  
 1966/67  
 1967/68  
 1968/69  
 1969/70  
 1970/71  
 1971/72  
 1972/73  
 1973/74  
 1974/75  
 1975/76  
 1976/77  
 1977/78  
 1978/79  
 1979/80  
 1980/81  
 1981/82  
 1982/83  
 1983/84  
 1984/85  
 1985/86  
 1986/87  
 1987/88  
 1988/89  
 1989/90  
 1990/91  
 1991/92  
 1992/93  
 1993/94  
 1994/95  
 1995/96  
 1996/97  
 1997/98  
 1998/99  
 1999/00  
 2000/01  
 2001/02  
 2002/03  
 2003/04  
 2004/05  
 2005/06  
 2006/07  
 2007/08  
 2008/09  
 2009/10  
 2010/11  
 2011/12  
 2012/13  
 2013/14  
 2014/15  
 2015/16  
 2016/17  
 2017/18  
 2018/19  
 2019/20  
 2020/21  
 2021/22  
 2022/23  
 2023/24  
 2024/25  
 2025/26  
 2026/27  
 2027/28  
 2028/29  
 2029/30  
 2030/31  
 2031/32  
 2032/33  
 2033/34  
 2034/35  
 2035/36  
 2036/37  
 2037/38  
 2038/39  
 2039/40  
 2040/41  
 2041/42  
 2042/43  
 2043/44  
 2044/45  
 2045/46  
 2046/47  
 2047/48  
 2048/49  
 2049/50  
 2050/51  
 2051/52  
 2052/53  
 2053/54  
 2054/55  
 2055/56  
 2056/57  
 2057/58  
 2058/59  
 2059/60  
 2060/61  
 2061/62  
 2062/63  
 2063/64  
 2064/65  
 2065/66  
 2066/67  
 2067/68  
 2068/69  
 2069/70  
 2070/71  
 2071/72  
 2072/73  
 2073/74  
 2074/75  
 2075/76  
 2076/77  
 2077/78  
 2078/79  
 2079/80  
 2080/81  
 2081/82  
 2082/83  
 2083/84  
 2084/85  
 2085/86  
 2086/87  
 2087/88  
 2088/89  
 2089/90  
 2090/91  
 2091/92  
 2092/93  
 2093/94  
 2094/95  
 2095/96  
 2096/97  
 2097/98  
 2098/99  
 2099/00  
 2100/01  
 2101/02  
 2102/03  
 2103/04  
 2104/05  
 2105/06  
 2106/07  
 2107/08  
 2108/09  
 2109/10  
 2110/11  
 2111/12  
 2112/13  
 2113/14  
 2114/15  
 2115/16  
 2116/17  
 2117/18  
 2118/19  
 2119/20  
 2120/21  
 2121/22  
 2122/23  
 2123/24  
 2124/25  
 2125/26  
 2126/27  
 2127/28  
 2128/29  
 2129/30  
 2130/31  
 2131/32  
 2132/33  
 2133/34  
 2134/35  
 2135/36  
 2136/37  
 2137/38  
 2138/39  
 2139/40  
 2140/41  
 2141/42  
 2142/43  
 2143/44  
 2144/45  
 2145/46  
 2146/47  
 2147/48  
 2148/49  
 2149/50  
 2150/51  
 2151/52  
 2152/53  
 2153/54  
 2154/55  
 2155/56  
 2156/57  
 2157/58  
 2158/59  
 2159/60  
 2160/61  
 2161/62  
 2162/63  
 2163/64  
 2164/65  
 2165/66  
 2166/67  
 2167/68  
 2168/69  
 2169/70  
 2170/71  
 2171/72  
 2172/73  
 2173/74  
 2174/75  
 2175/76  
 2176/77  
 2177/78  
 2178/79  
 2179/80  
 2180/81  
 2181/82  
 2182/83  
 2183/84  
 2184/85  
 2185/86  
 2186/87  
 2187/88  
 2188/89  
 2189/90  
 2190/91  
 2191/92  
 2192/93  
 2193/94  
 2194/95  
 2195/96  
 2196/97  
 2197/98  
 2198/99  
 2199/00  
 2200/01  
 2201/02  
 2202/03  
 2203/04  
 2204/05  
 2205/06  
 2206/07  
 2207/08  
 2208/09  
 2209/10  
 2210/11  
 2211/12  
 2212/13  
 2213/14  
 2214/15  
 2215/16  
 2216/17  
 2217/18  
 2218/19  
 2219/20  
 2220/21  
 2221/22  
 2222/23  
 2223/24  
 2224/25  
 2225/26  
 2226/27  
 2227/28  
 2228/29  
 2229/30  
 2230/31  
 2231/32  
 2232/33  
 2233/34  
 2234/35  
 2235/36  
 2236/37  
 2237/38  
 2238/39  
 2239/40  
 2240/41  
 2241/42  
 2242/43  
 2243/44  
 2244/45  
 2245/46  
 2246/47  
 2247/48  
 2248/49  
 2249/50  
 2250/51  
 2251/52

200		ᱪᱟᱴᱚᱨ ᱦᱚᱱᱚᱛ ᱦᱚᱱᱚᱛ
160		ᱦᱚᱱᱚᱛ ᱦᱚᱱᱚᱛ 2
25		ᱦᱚᱱᱚᱛ ᱦᱚᱱᱚᱛ 2
160		ᱦᱚᱱᱚᱛ ᱦᱚᱱᱚᱛ 2

144		ᱦᱚᱱᱚᱛ ᱦᱚᱱᱚᱛ 8
56		ᱦᱚᱱᱚᱛ ᱦᱚᱱᱚᱛ 2
<u>7.45</u>		ᱦᱚᱱᱚᱛ ᱦᱚᱱᱚᱛ 2



17 July 1906

Order of the  
N. A. S. P. 1906  
N. A. S. P. 1906  
N. A. S. P. 1906  
N. A. S. P. 1906

816

מחיר	30-
מחיר	40-
מחיר	38-
מחיר	39-
מחיר	4-
מחיר	14-
מחיר	37-
מחיר	16-
מחיר	34-
מחיר	31-
מחיר	33-
מחיר	32-
מחיר	12-
מחיר	25-
מחיר	18-

מחיר	10-
מחיר	2-
מחיר	17-
מחיר	4-
מחיר	26-
מחיר	36-
מחיר	21-
מחיר	20-
מחיר	28-
מחיר	27-
מחיר	29-
מחיר	19-
מחיר	24-
מחיר	23-



20/2/2020 30 - 25  
 20/2/2020 40 -  
 20/2/2020 38 -  
 20/2/2020 39 -  
 20/2/2020 8 -  
 20/2/2020 14 -

20/2/2020 29  
 20/2/2020 19  
 20/2/2020 24  
 20/2/2020 23

20/2/2020 32 -  
 20/2/2020 18 -  
 20/2/2020 34 -  
 20/2/2020 31 -  
 20/2/2020 33 -  
 20/2/2020 32 -  
 20/2/2020 12 -  
 20/2/2020 28 -  
 20/2/2020 18 -

25  
 5  
 1.25  
 2.5  
 3.75  
 5.00  
 6.00

3.25  
 1.50  
 4.75

25  
 22  
 50  
 50  
 550  
 125  
 6.75

25  
 18 1/2 36  
 18 1/2 21  
 18 1/2 20-  
 2 1/2 28

10 1/2  
 2 1/2  
 1 1/2  
 7  
 4 1/2

23  
 19  
 24  
 27  
 16

22  
 20 1/2 12

3  
 10  
 12  
 10  
 12



1926 יאר 8 עשרה

30	עלוי	
13	פ. ג. ג. ג.	12.
6	ג. ג. ג.	
26	ג. ג. ג.	2
3	ג. ג. ג.	הגל
5	ג. ג. ג.	
14	ג. ג. ג.	
14	ג. ג. ג.	
14	ג. ג. ג.	

1st  
1st  
2nd  
3rd

2

1

1-

1st

1-

3-

1-

1-

2-

4-



פער גוט

200 פער גוט

125 פער

20 פער

12 פער

5 פער

---

פער זיכער

40 פער

20 פער

2 פער

---

פער

25 פער

20 פער

6 פער

1926. 8. 26

1. 12  
 + 1. 15 2-  
 2. 15 1-  
 3. 15 1-  
 4. 15 18-  
 5. 15 1-  
 6. 15 3-

1. 12  
 2. 15 3-  
 3. 15 1-  
 4. 15 1-  
 5. 15 1-  
 6. 15 1-

1. 15 10  
 2. 15 18  
 3. 15 5  
 4. 15 1-  
 5. 15 2-  
 6. 15 2-

1. 15 3-  
 2. 15 3-  
 3. 15 3-  
 4. 15 4-  
 5. 15 1-  
 6. 15 1-



giml bair abf

11 D X f P 2, 6 n 1 2 3 2 10.  
nl 2 P 4 3 f 5 5 2 2

tes ches zaim var hey daled giml bair abf

6 n 3 1 2 2 2 2 10

langer-nun schlos-mem lanned, langer-chof-ud

1 langer-chadied langer-fay pay ien same  
f 3 f 5 5 2 2 0

raize kub  
2 P

This is a round pillbox. Grosgrain, <sup>tiny</sup> bows  
 on both sides. Left one holds the veil,  
 as shown in fig. 1. Or, like fig. 2, both  
 bows hold the veil. Gathering at the  
 top make it large enough to come  
 wide a part. Hook-like shape of like  
 dots holds

both together.

Mr. Blue, Gold,  
 Black, Brown,  
 Wine. Straw  
 or felt. Liger



Fig. 1



Fig. 2

21-23.

No. 200



$$\begin{array}{r}
 1 \\
 \hline
 5 \\
 \hline
 4 \\
 \hline
 0 \\
 \hline
 1 \\
 \hline
 2 \\
 \hline
 1 \\
 \hline
 4
 \end{array}$$

$$\begin{array}{r}
 5 \\
 \hline
 1 \\
 \hline
 2 \\
 \hline
 4 \\
 \hline
 2 \\
 \hline
 5 \\
 \hline
 3
 \end{array}$$

$$\begin{array}{r}
 4 \\
 \hline
 1 \\
 \hline
 0 \\
 \hline
 7 \\
 \hline
 4 \\
 \hline
 6 \\
 \hline
 2 \\
 \hline
 8
 \end{array}$$

$$\begin{array}{r}
 5 \\
 \hline
 1 \\
 \hline
 3 \\
 \hline
 1 \\
 \hline
 3 \\
 \hline
 4 \\
 \hline
 0 \\
 \hline
 4
 \end{array}$$

$$\begin{array}{r}
 2 \\
 \hline
 2 \\
 \hline
 3 \\
 \hline
 5 \\
 \hline
 0 \\
 \hline
 5 \\
 \hline
 7 \\
 \hline
 2 \\
 \hline
 4 \\
 \hline
 8 \\
 \hline
 3 \\
 \hline
 3
 \end{array}$$

10 Minut

Books



School Stuff



Erasen

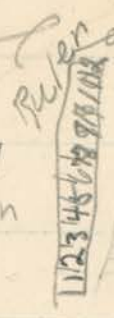



76

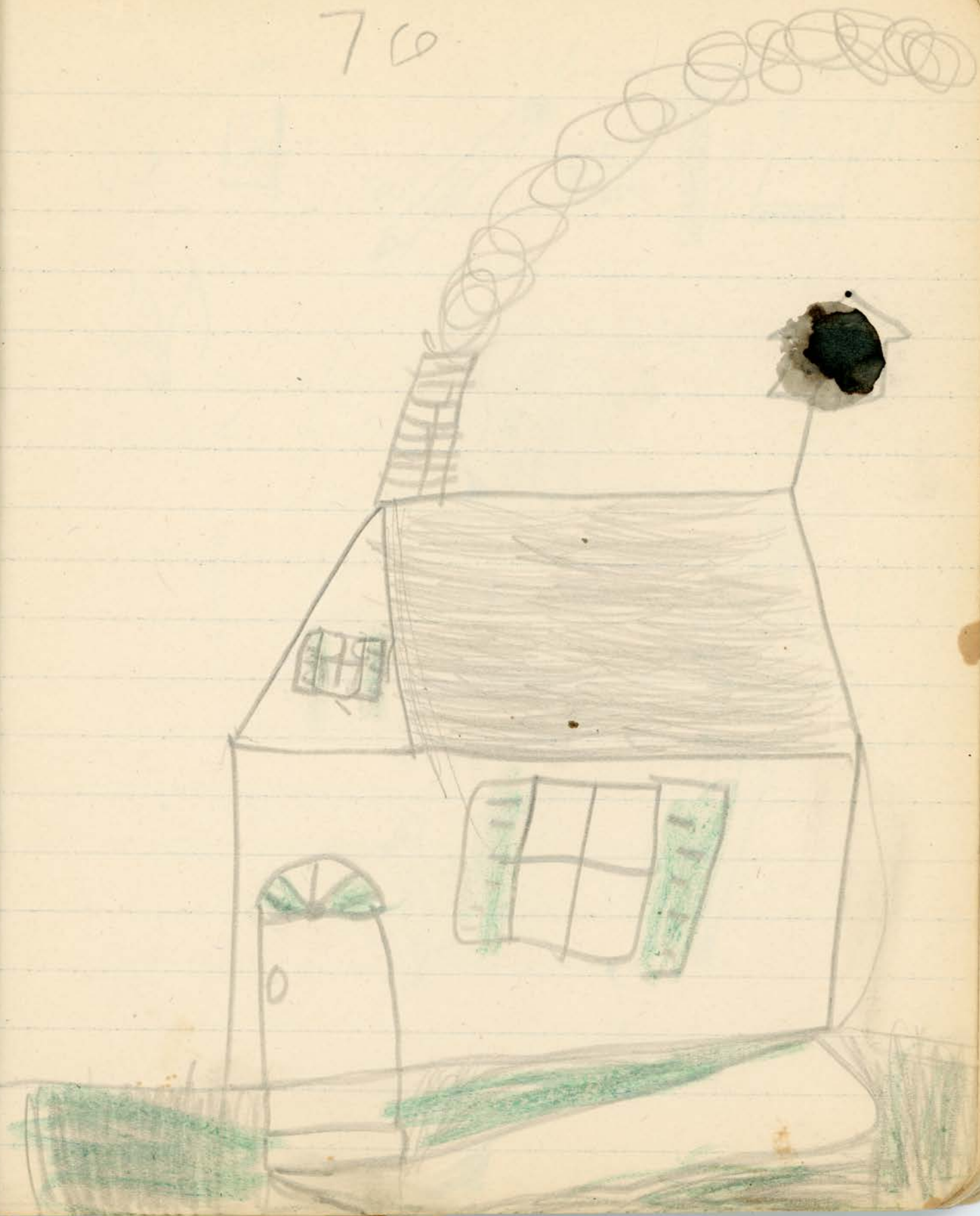

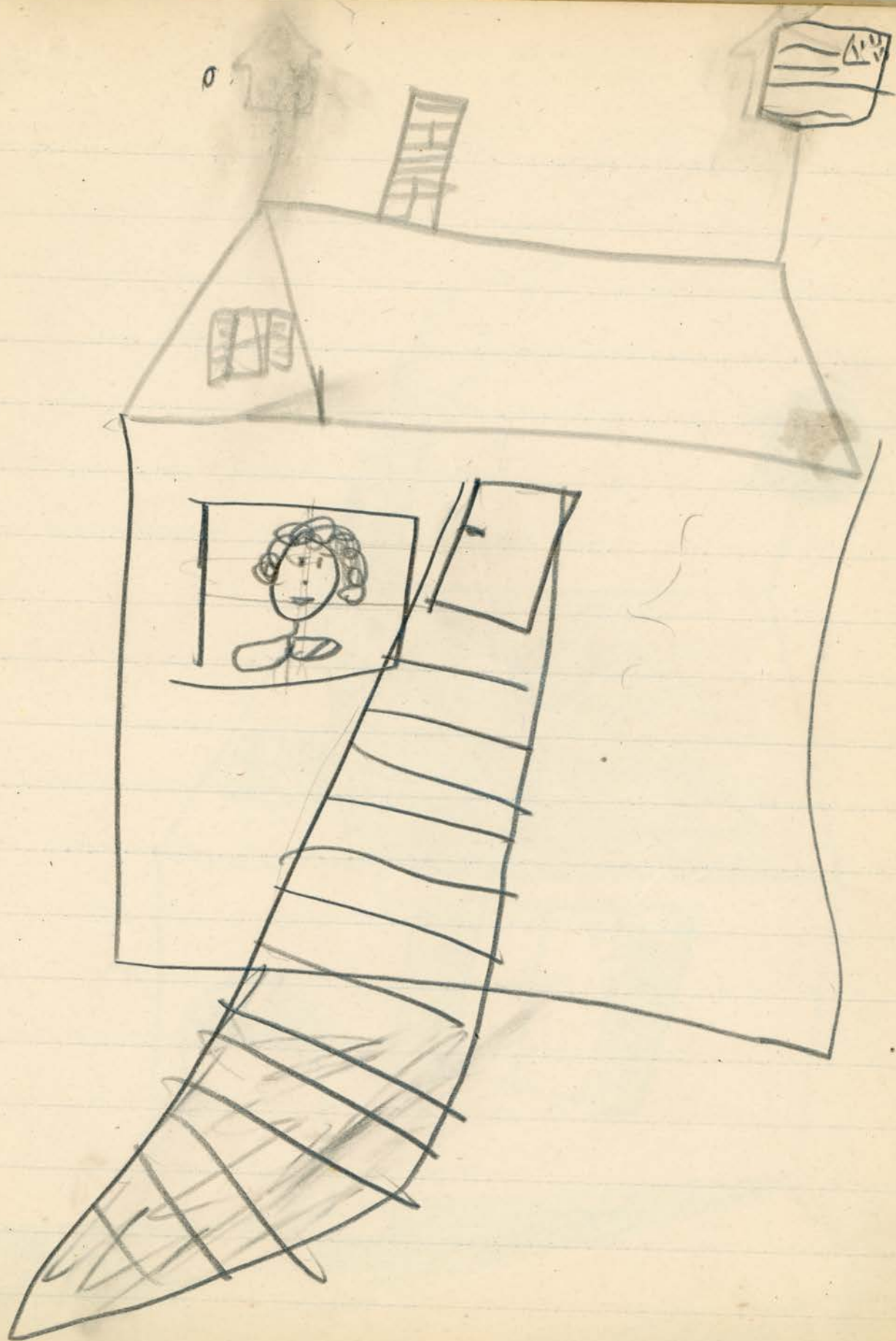



Case 49261

1/2  
 1/4  
 3-  
 1-  
 1/2

3-  
 1/2-  
 1-  
 1/2-

1-  
 3-  
 1-  
 2-  
 1/2-  
 2-

1-  
 2-  
 2-  
 1-  
 4-

1-  
 1-  
 1-  
 3-  
 2-

5-  
 1-  
 1-  
 1/2-  
 2-  
 3-



754 ~~1926~~  
1926

1926 2/26/20

1926

Gallinule  
2 Sh 15  
6 Sh 15  
1 Sh 2  
1 Sh 1

1926  
2 Sh 15  
1 Sh 5  
1 Sh 1

1926  
1926

2 Sh 15  
1 Sh 10  
1 Sh 3  
1 Sh 1/2

1926  
2 Sh 15  
1 Sh 10  
1 Sh 1

1926  
2 Sh 5  
1 Sh 5  
1 Sh 1  
2 Sh 2

Gallinule  
2 Sh 15  
1 Sh 10  
1 Sh 2

1926  
2 Sh 10  
1 Sh 5

1926  
2 Sh 15  
1 Sh 10  
1 Sh 1  
1 Sh 1/2  
1 Sh 3





10  
 5  
 1  
 2

2  
 20  
 10  
 1

5  
 5  
 2  
 1

2  
 35  
 15  
 3

2  
 10  
 5  
 2  
 2

10  
 10  
 1

2  
 20  
 20  
 20

10  
 5  
 2  
 2

12

1966



94

1924, 14 Jan 1924

5  
Conf 40

— 20

30

2. The Earl  
of  
Glen  
Glen

\_\_\_\_\_

22.10.72

30

१११/० १

30

65

23.6 14

1018 65

Sept 15

Aug 20

30 June

22. 10 7

50

50

25

16

521

52  
290

8,64

30

-30

30

30

30

30

50

30

30

290

ms 268 61

1556. 62

10 5 7 8 9

30

W. H. J. 178

26/11/90

22nd Nov 23 1924

21. *Phragmites*

Ms. B. 50

21

2010 2

21

21.02.24 J. Th. A. D.

42

21

Aug 35 to Sep 65 21

21 7850, 1190798

20

140607 65 42 7/120 202

200  
21  
21  
21  
21  
42

208  
214  
222

[illegible]



14 15 16 17 18 19 20 21 22 23 24 25 26 27 28 29 30 31 32 33 34 35 36 37 38 39 40 41 42 43 44 45 46 47 48 49 50 51 52 53 54 55 56 57 58 59 60 61 62 63 64 65 66 67 68 69 70 71 72 73 74 75 76 77 78 79 80 81 82 83 84 85 86 87 88 89 90 91 92 93 94 95 96 97 98 99 100

86

4/9

5/8

9/4/8

3

1/5

1/5

1/5

1/5

1/5

1/5

1/5

1/5

1/5

946

1096

150

21

1096

1117

1/5

50

21

21

21

21

21

21

21

21

21

21

21

21

21

21

21

21

21

21

21

1/5

1/5

1/5

1/5

1/5

1/5

1/5

1/5

1/5

1/5

1/5

1/5

1/5

1/5

1/5

1/5

1/5

1/5

1/5

1/5

6.8

65

21

4.9

35  
 15  
 2

---

35  
 15  
 2

---

15  
 10

---

1  
 3

---

10  
 10  
 1

---

25  
 15  
 3

---

5  
 5  
 2

---

8  
 5

---





1/2 1/2 1/2 1/2

1/2 1/2 1/2 1/2 15

1/2 1/2 1/2 1/2 5

1/2 1/2 1/2 1/2 1

1/2 1/2 1/2 1/2 1

1/2 1/2 1/2 1/2 1

1/2 1/2 1/2 1/2 1

1/2 1/2 1/2 1/2 1

1/2 1/2 1/2 1/2 1

1/2 1/2 1/2 1/2 1

1/2 1/2 1/2 1/2

1/2 1/2 1/2 1/2

1/2 1/2 1/2 1/2

1/2 1/2 1/2 1/2

1/2 1/2 1/2 1/2

1/2 1/2 1/2 1/2

1/2 1/2 1/2 1/2

1/2 1/2 1/2 1/2

1/2 1/2 1/2 1/2 20

1/2 1/2 1/2 1/2 10

1/2 1/2 1/2 1/2 2

1/2 1/2 1/2 1/2 1

1/2 1/2 1/2 1/2 1

H

2-2=0



מספר י. סוף

מספר 10  
מספר 5  
מספר 2

מספר 10

מספר 10

מספר 3

מספר 1

מספר 2

מספר 3

מספר 10

מספר 5

מספר 2

מספר 1

מספר 15

מספר 3

מספר 5

מספר 1

מספר סוף

מספר 20

מספר 10

מספר 2

מספר 1

מספר 10

מספר 1

מספר 14

מספר 1

מספר 2

מספר 3

מספר 3

מספר סוף

מספר 15

מספר 10

מספר 5

מספר 1

מספר 2

גריס סעמ

גריס 4

גריס 2

גריס 2

גריס 1

גריס 3 גריס 2

1 גריס 15  
גריס 10

גריס סעמ

גריס 35

גריס 10

גריס 5

גריס סעמ

A.C. 14

גריס 2, גריס 1

גריס 2

גריס 1

גריס 5

גריס סעמ

גריס 250

גריס 165

גריס 15

גריס 27

גריס 6

גריס 35

גריס 30

גריס 12

גריס 11

גריס 6

גריס 15

גריס 15

גריס 18

גריס 2

גריס 1

גריס 1

גריס סעמ

85 גריס

35 גריס

5 גריס

2 גריס



5 1/2 lbs of mints  
5 " flour

2 ginger

1 cinnamon

~~2 1/2 lbs of prunes.~~

~~2 1/2 lbs of H. saddish~~

~~2 lbs of cake flour~~

~~2 1/2 lbs of tea~~

~~5 1/2 lbs of 5 10 10~~

~~5 1/2 lbs of 5 10 3~~

~~P. Schudtz~~

1 the present office

1 the 2nd

1 the 3rd

2 the 4th

2 the 5th

1 the 6th

1 the 7th

1330

~~16~~ 20



11/12 Dec

11/12 Dec

11/12 Dec

11/12 Dec

76

27 Jan 1  
Feb 2  
Mar 2  
Apr 2  
May 1

787

2130  
598

1522

375  
1698

Page 20

11/12 Dec